

GENERAL TRAFFIC CONTROL NOTES

1. TEMPORARY TRAFFIC CONTROL SHALL BE IN ACCORDANCE WITH CURRENT ODOT STANDARD DETAILS AND SPECIFICATIONS AND ALSO WITH THE "MANUAL ON UNIFORM TRAFFIC CONTROL DEVICES" (MUTCD) (CURRENT EDITION).
2. THE CONTRACTOR SHALL BE RESPONSIBLE FOR TEMPORARY STORAGE OF TEMPORARY TRAFFIC CONTROL DEVICES DURING PERIODS OF NON-USE.
3. ALL PERMANENT TRAFFIC SIGNS CONFLICTING WITH TEMPORARY TRAFFIC CONTROL DEVICES SHALL BE COVERED WHEN TEMPORARY TRAFFIC CONTROL DEVICES ARE IN USE.
4. THIS TRAFFIC CONTROL PLAN SHALL BE USED AS GUIDANCE FOR THE CONTRACTOR TO PRODUCE HIS OWN TRAFFIC CONTROL PLAN THAT WILL BE SUBMITTED TO THE ODOT DIVISION AND THE OWNER FOR APPROVAL BEFORE HE BEGINS CONSTRUCTION.
5. THIS PLAN IS INTENDED TO SHOW ALL AREAS OF CONSTRUCTION AND HOW THEY WILL BE TREATED FOR TRAFFIC CONTROL. ALL AREAS WILL NOT NEED TRAFFIC CONTROL AT ONCE. TRAFFIC CONTROL WILL BE DONE BY THE STREET THAT IS UNDER CONSTRUCTION AT THE TIME. THEREFORE MANY SIGNS AND CHANNELIZING DEVICES MAY BE RE-USED DURING THE CONSTRUCTION.
6. WHENEVER THE CONTRACTOR IS PERFORMING A CONSTRUCTION ACTIVITY ON THE SIDEWALK OR THE STREET EVEN AFTER THE MAJOR CONSTRUCTION HAS BEEN COMPLETED AND THE TRAFFIC CONTROL DEVICES HAVE BEEN REMOVED, THE CONTRACTOR SHALL PUT IN PLACE TRAFFIC CONTROL TO PROTECT THE PUBLIC FROM THE AREA HE IS WORKING IN.
7. THE USE OF FLAGMEN WILL BE UTILIZED AS NEEDED TO ALLOW EQUIPMENT AND TRUCKS IN AND OUT OF BARRICADE ZONES.
8. FOR ADDITIONAL INFORMATION ABOUT TAPER LENGTHS AND SPACING OF CHANNELIZING DEVICES, SEE STANDARD DRAWING TCS2-1 (LATEST REVISION)
9. ANY LANE CLOSURES MUST BE COORDINATED WITH THE CITY OF SKIATOOK PRIOR TO THE WORK. THE DAYS REQUESTED FOR APPROVAL MUST BE SPECIFIED BY THE CONTRACTOR.

OKLAHOMA DEPARTMENT OF TRANSPORTATION					
FED. ROAD DIST. NO.	STATE	PROJ. NO.	FISCAL YEAR	SHEET NO.	TOTAL SHEETS
6	OKLA.	28839(04), 32530(04)			
DESCRIPTION			REVISIONS	DATE	

LEGEND

- TRAFFIC SIGN
- BARRICADE
- CHANNELIZING DEVICE (MAY CONSIST OF DRUMS, TUBULAR MARKERS, VERTICAL PANELS OR CONES)

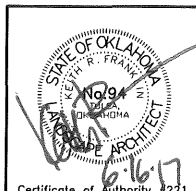
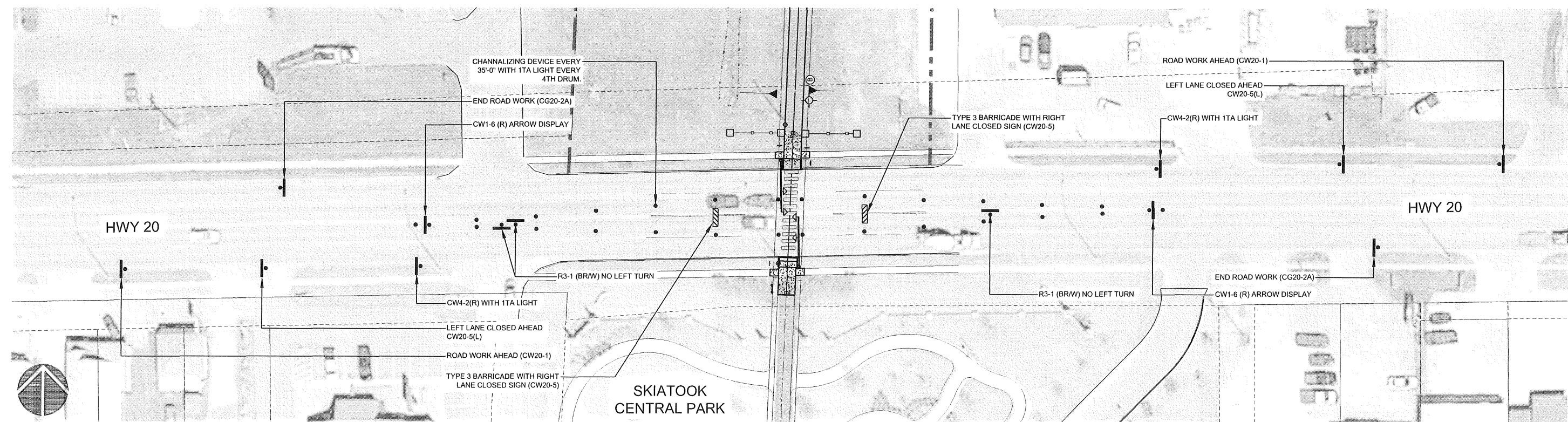
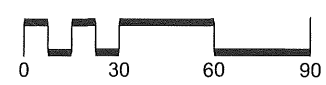
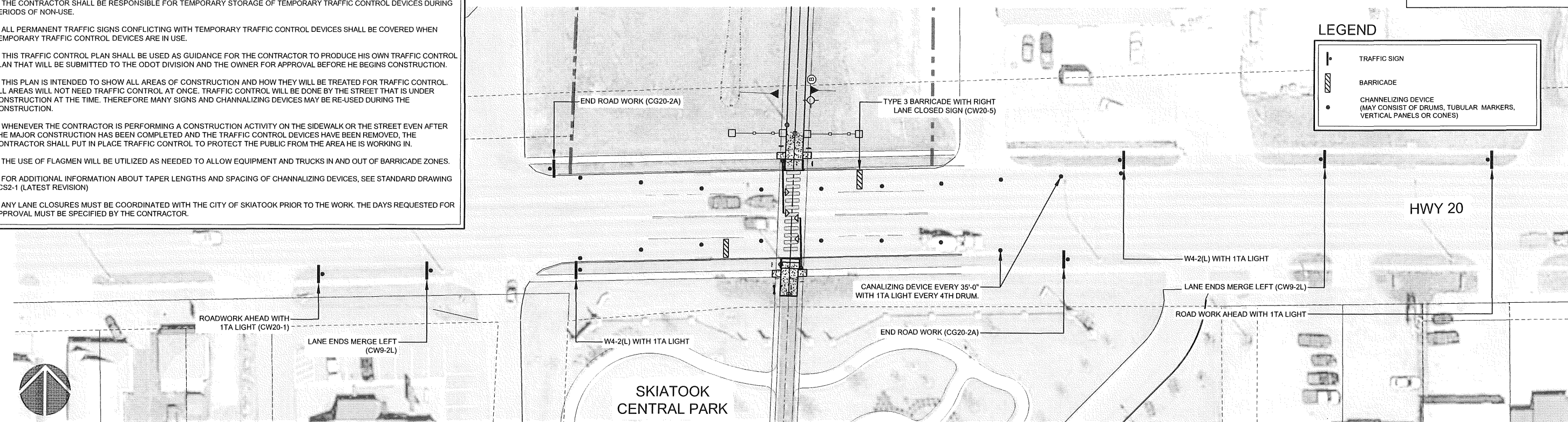

Osage Prairie Trail Extension			PREPARED BY: LANDPLAN CONSULTANTS 1110 West 23rd Street TULSA, OK 74107 918-584-6454		
Design	JM	8/16	TRAFFIC CONTROL PLAN State Job No. 28839 (04), 32530 (04) Sheet No. 6 of 32		
Drawn	JM/BB	8/16			
Checked	JM/KF	6/17			
Approved					
Squad					

F:\581 Osage Prairie Trail Ext\Final\CAD BASE Files\Final\CAD Base Files\Traffic Control and Lighting Plan.dwg, 6/14/2017 4:38:49 PM